

# VENTILATION SYSTEMS



## DUCT PIECES

QASAIR rangehoods must be vented to the outside atmosphere by the use of zincalume duct or non-porous and non-flammable material.



## Some General Rules to be aware of:

**QASAIR RANGEHOODS** are designed to capture all the by products produced by all the domestic cookware available in Australia.

Standard bench tops are 600 mm deep.

**If the bench top is going to be 700 mm or 800 mm deep then you will need to advise the sales person.**

**If the bench top is 800 deep and overhead cupboard is 300 mm, the rangehood will not do the job required.**

If the cooking appliances measure more than 1000 mm then we recommend two motors in the hood.

If a barbecue, wok burner or a teppanyaki plate are being installed then two motors must be used to ensure the necessary air movement is achieved.

**1 Use the correct size ducting otherwise the air movement will be reduced.**

2 Use non-flammable ducting to avoid fires burning through plastic ducting.

3 Do not use flexible ducting as eddies result along the sides causing a disturbance which reduces the air flow by half.

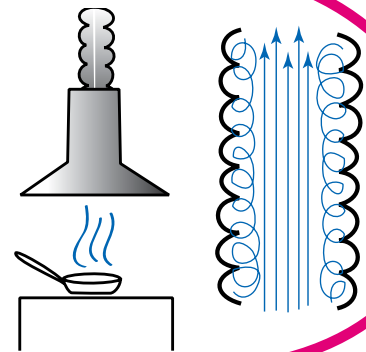

4 Do not duct into the ceiling as odours will come out in another room and could be a fire hazard. Duct to the outside atmosphere.

5 Do not have sharp bends as 90° bends can reduce air flow by 20% to 25%. All bends must be streamlined.

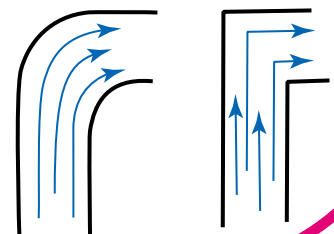

6 Duct to the outside atmosphere in the shortest distance. The longer the duct run will result in a drop in the air movement.

7 Do not use a QASAIR rangehoods over cooking appliances with a Mega Joule rating of 50 mj and over. Condari P/L will make rangehoods to work over these appliances.

# Did You Know

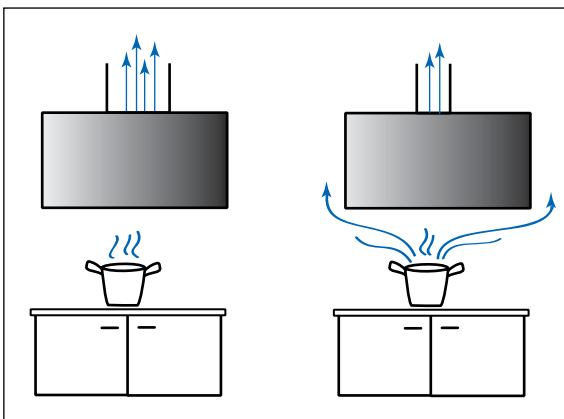
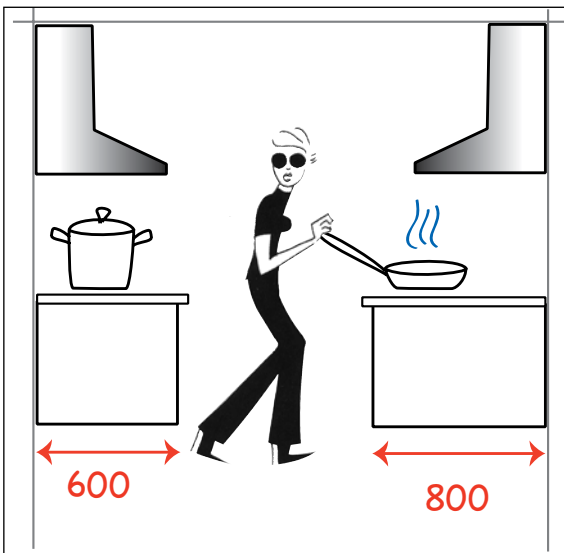

# GETTING IT RIGHT THE FIRST TIME

## AIR MOVEMENT

QASAIR Rangehoods recommend a minimum air movement of 1400 cubic metres per hour – and therefore, a minimum of two motors over the following appliances:

- indoor barbecues
- deep fryers
- wok burners
- fish burners
- griddle plates
- high speed gas grillers
- teppanyaki plates

## METAL DUCTING

QASAIR recommend the use of rigid, metal ducting, and specify minimum dimensions for one, two or three motors. This duct size must not be reduced. QASAIR Rangehoods can be either top or back ducted.

## OUTSIDE ATMOSPHERE

QASAIR Rangehoods recommend that all rangehoods be ducted to the outside atmosphere. Ducting into the ceiling space can cause leakage of smoke and odours into other parts of the house through joints and light fittings, and can also be a dangerous fire hazard.

## PLAN AHEAD

Where possible, ducting should be considered during the planning stage, or at least, frame stage. Every kitchen designer should consider the duct layout and the space required for duct work

when designing a kitchen.

## INSTALLATION

QASAIR Rangehoods are capable of extracting enormous quantities of air. A three motor QASAIR Rangehood has a maximum air movement of 2700 cubic metres of air per hour. Therefore, the effective design and dimensions of duct work is critical to the proper installation of the rangehood. The duct type or construction can significantly effect the performance of the rangehood. Bends, deflections and excessive length can also reduce the effectiveness of the rangehood by up to 70%. Other factors such as room size, height over the benchtop and the type of cooking appliances being used should also be considered when deciding on the rangehood and appropriate ducting.

## TAKE THE RESPONSIBILITY

It is the responsibility of the client to inform the architect, kitchen designer, builder or cabinetmaker which QASAIR Rangehood they will be using, so that provisions for it can be made during construction.

It is also advised that the tradespeople on site are made aware of the special and specific requirements of QASAIR Rangehoods.

**Always seek the recommendation and specifications of the manufacturer.**

# FOUNDATION FOR EXCELLENCE

QASAIR Rangehoods are at the forefront of design and innovation in kitchen appliances. The objective has always been to retain the purposeful ability to function in all domestic kitchens and also making them quieter so normal conversation can be carried out while cooking.

Since 1990 Condari Pty Ltd has consulted with the CSIRO to examine ways to achieve and improve this. Qasair Rangehoods have a decibel rating of 50 or less. Now with one model tested at 36.7 db on high speed. We will continue to improve our rangehoods and to introduce more models to enhance modern designed kitchens.

The following pages show diagrammatically all the ducting pieces we manufacture.

We will also make special ducting pieces where necessary if the standard ones will not fit. If the installer tells us what is required we will make and deliver within 3 to 5 working days. It is important to keep the correct cross sectional area the same for the outlet of the motor or motors.

## **QASAIR Rangehoods are manufactured in Australia.**

QASAIR have been manufacturing rangehoods in Victoria for over forty years.

Helmut Goetz, a German engineer, who began manufacturing at a factory in Hawthorn in 1968, developed the original concept. His engineering credentials provided the foundation for the excellent performance for which QASAIR is known.

The factory is now located in Ringwood Victoria 3134, and QASAIR Rangehoods are distributed all over Australia. They are also exported into Asia and New Zealand.

QASAIR is committed to maintaining high air movement with minimal noise.

QASAIR has positioned itself at the forefront of the quality domestic cookware industry.

One of the major challenges confronting QASAIR Rangehoods is to manufacture a product which not only attains the highest standard of performance, but that is also innovative in design in an intensely competitive market. QASAIR's success is a tribute to a company, which continually strives for excellence in an unending quest for improvement.



# PERFECTION IN METAL

QASAIR is perfection in metal. It incorporates a ventilation system, which is both visually pleasing and efficient over all domestic cooking appliances, whilst also achieving an unequalled level of quietness.

QASAIR has taken rangehoods to the next level by reducing the noise emission to below that of other kitchen appliances.

QASAIR showcases the very latest in Australian design for Australian conditions. The QASAIR range reveals a selection of creative designs in the most modern styling. Boasting an array of sensual lines, which immediately create a striking presence, QASAIR hoods retain the purposeful ability to function over all domestic cooking equipment available on the Australian market today.

By using advanced technology combined with the latest automated techniques, QASAIR offers functionality with superb design.



**SINGLE MOTOR  
DUCTING**  
I/D Internal Diameter

**NOTE:**  
This Zinc Alume Strip is provided to join some duct pieces together. It will be clearly shown on the drawing of the piece it is supplied with.

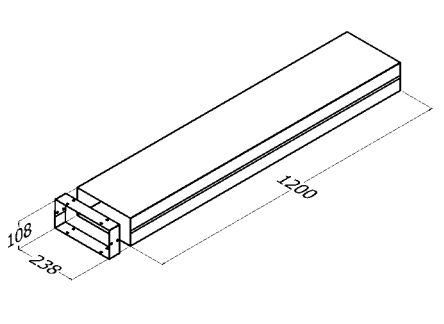
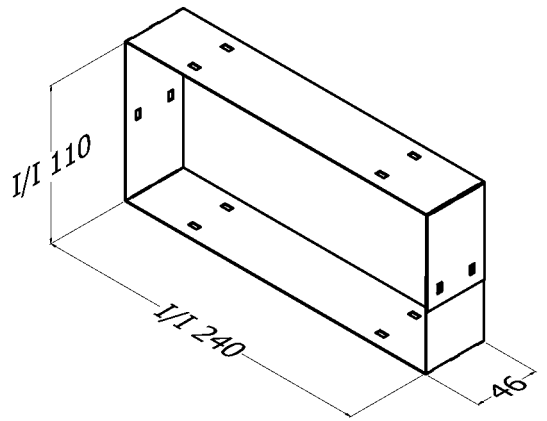

**101. DL-1** Duct Length 1200mm  
DL-1C Duct Length (coloured)

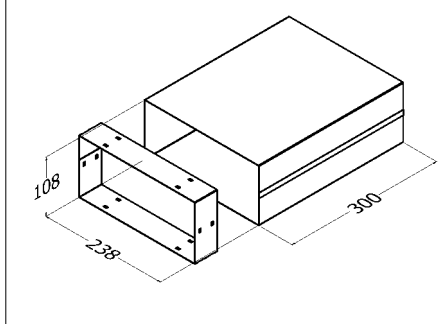

**101. DL-1A**  
Duct Length 300mm

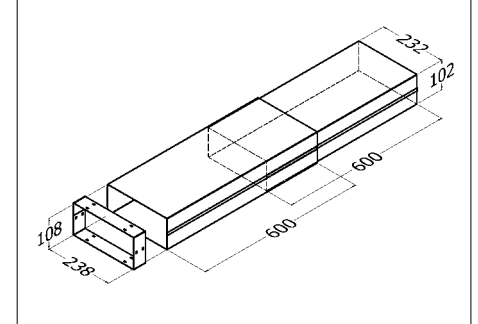

**101. DL-1E**  
Duct Length Extensible 1200mm

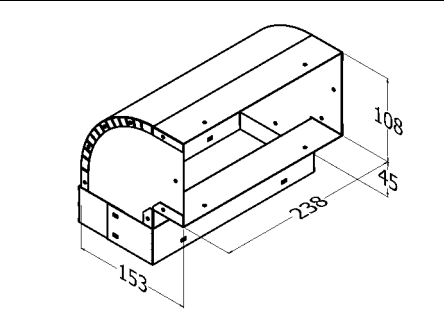

**102. HB-1**  
Horizontal Bend 90°

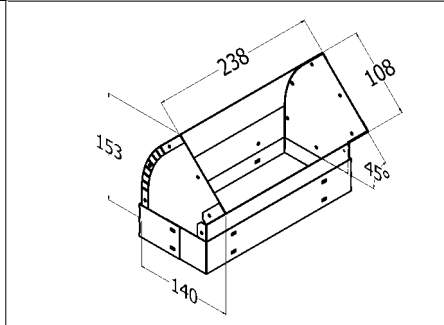

**103. HB-1/45**  
Horizontal Bend 45°

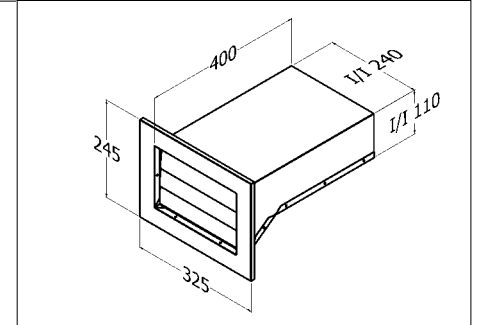

**104. BD/WV-H-1**  
Back Draft Wall Vent Horizontal

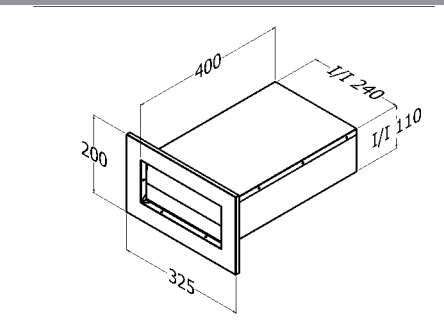

**105. BD/WV-H-1 MGS**  
Back Draft Wall Vent Horizontal  
Marine Grade Stainless Steel

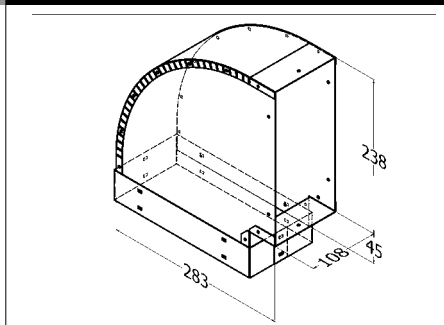

**106. VB-1**  
Vertical Bend 90°

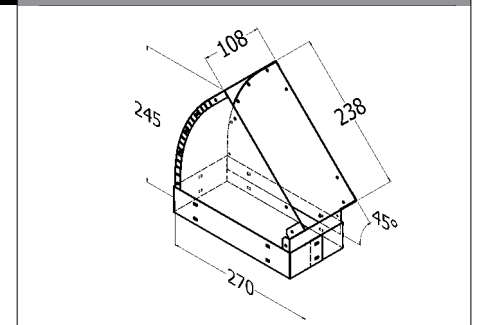

**107. VB-1/45**  
Vertical Bend 45°

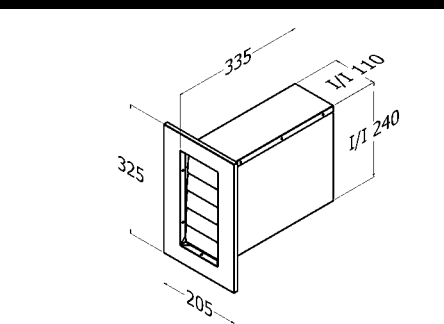

**108. BD/WV-V-1**  
Back Draft Wall Vent Vertical

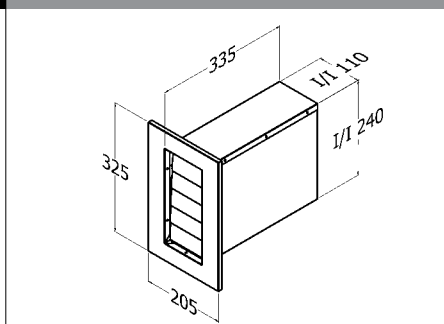

**109. BD/WV-V-1 MGS**  
Back Draft Wall Vent Vertical  
Marine Grade Stainless Steel

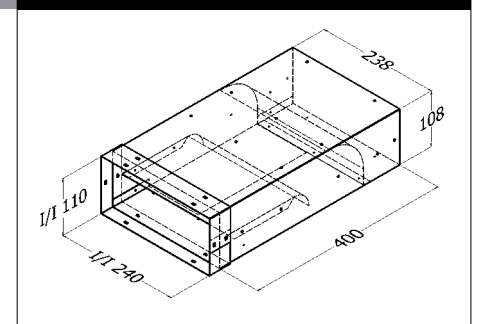

**110. DD-1-L**  
Duct Director Left

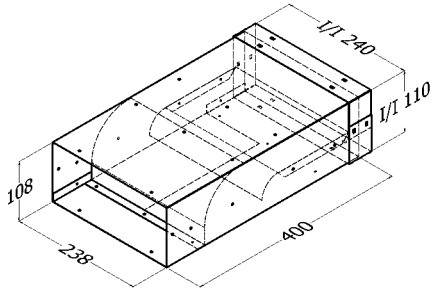

**111. DD-1-R**  
Duct Director Right

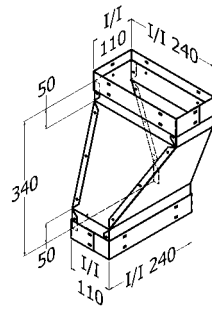

**112. TT-1**  
Twisted Transition

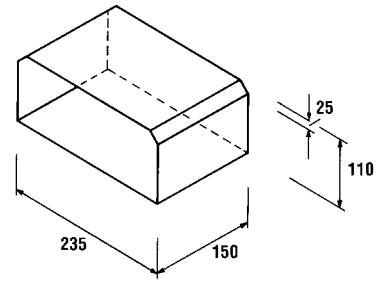

**113. DLE-DLE**  
Flue Joiner

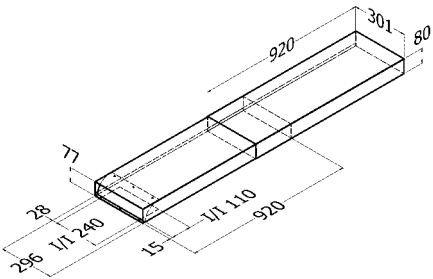

**114. CD-920**  
Cavity Duct Extendable

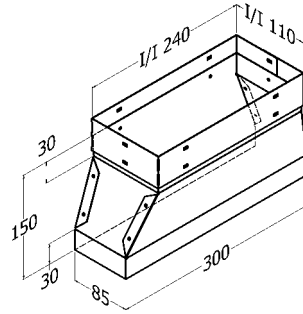

**115. CD-920 to DL-1**  
Cavity Duct to Duct Length

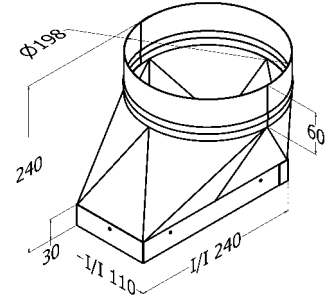

**116. TR-1**  
Rectangular to Round Transition

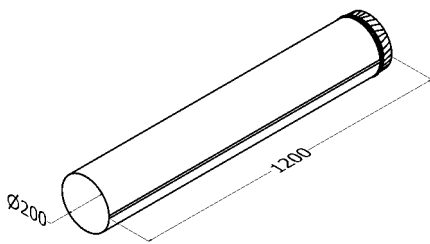

**117. DR-200**  
Round Duct Length 1200mm

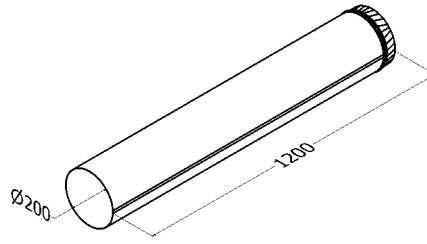

**118. DR-200 CB**  
Round Duct Length 1200mm Colourbond

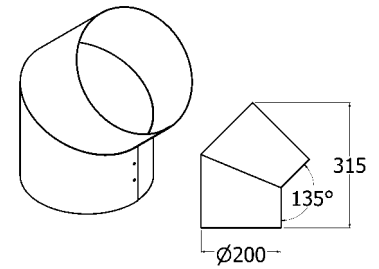

**119. DR-200/45**  
Round Bend 45°

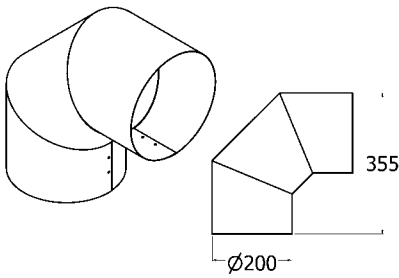

**120. DR-200/90**  
Round Bend 90°

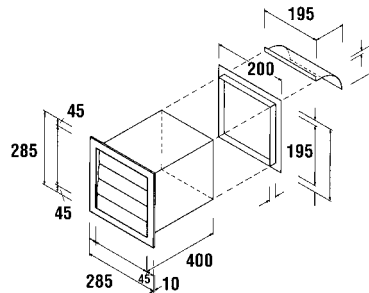

**121. BD-6/7/9 WV-R/R**  
Rear Register Kit

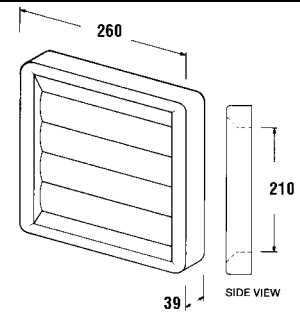

**122. AS-20**  
Back Draft Shutter

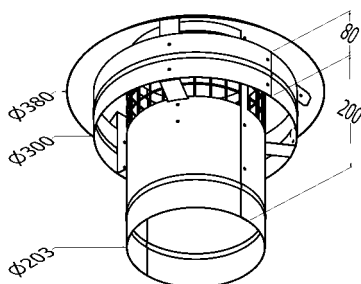

**123. CH-200**  
Chairman's Hat

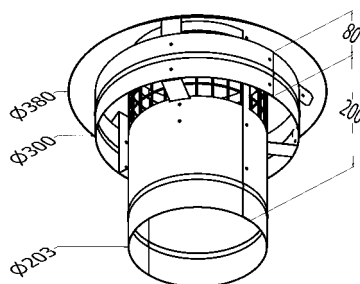

**124. CH-200 CB**  
Chairman's Hat Colourbond

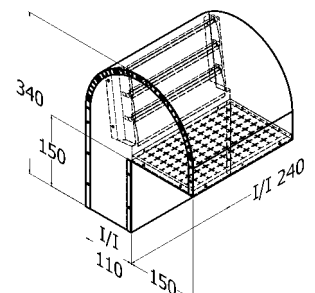

**125. BD/RC-1**  
Back Draft Roof Cowl

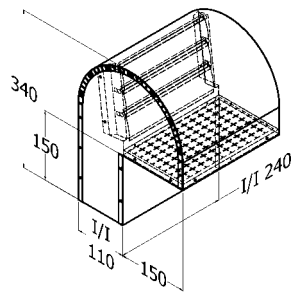

**126. BD/RC-1 CB**  
Back Draft Roof Cowl Colourbond

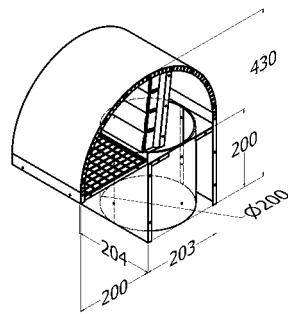

**127. BD/SQ-RC 200**  
Back Draft Roof Cowl 200ø

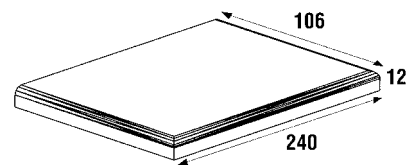

**128. DLE-S/S CAP**  
Stainless Steel Cap

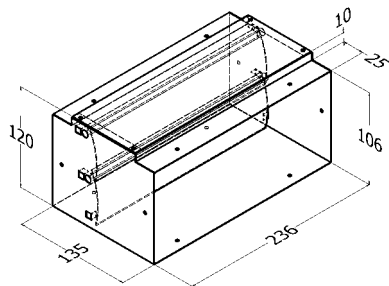

**129. BD/M-1**  
Back Draft Damper

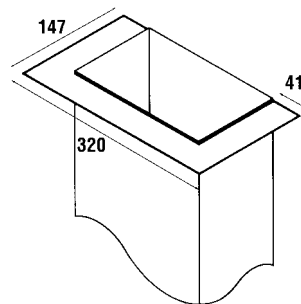

**130. CF-6/7/900H**  
Ceiling Flange 6/7/900H

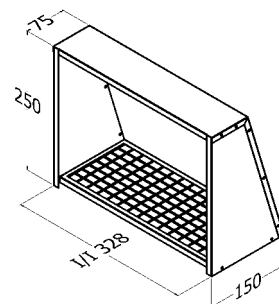

**131. WVC-H-1**  
Wall Vent Cover Horizontal

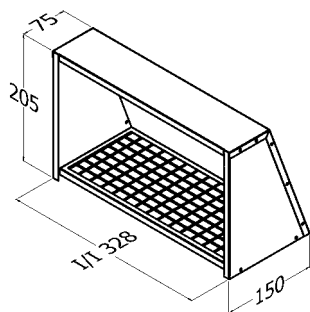

**132. WVC-H-1 MGS**  
Wall Vent Cover Horizontal  
Marine Grade Stainless Steel

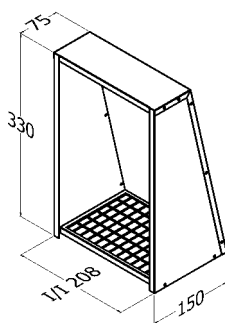

**133. WVC-V-1**  
Wall Vent Cover Vertical

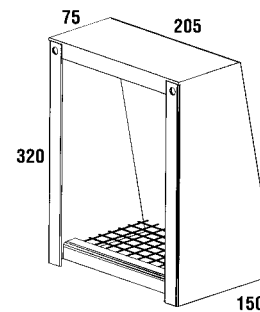

**134. WVC-V-1 MGS**  
Wall Vent Cover Vertical  
Marine Grade Stainless Steel

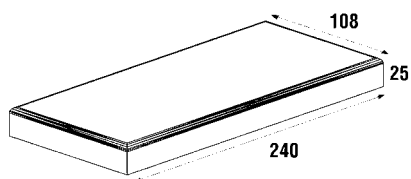

**135. 6/7/900H-SC**  
Spigot Cap

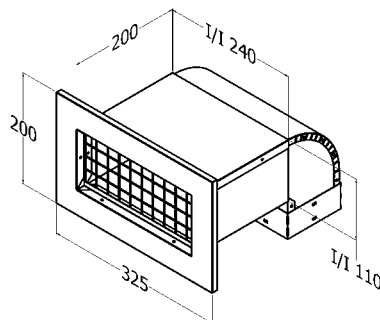

**136. EV/DL-1**  
Eave Vent Suit DL-1

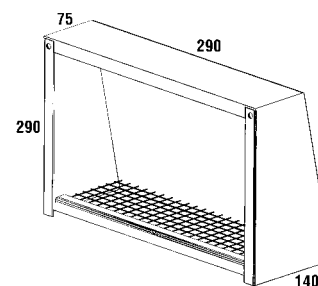

**137. WVC-6/7/9H-R/R**  
Wall Vent Cover

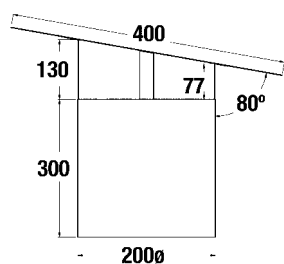

**138. RCP-200 S/S**  
Roof Cap 200ø Stainless Steel

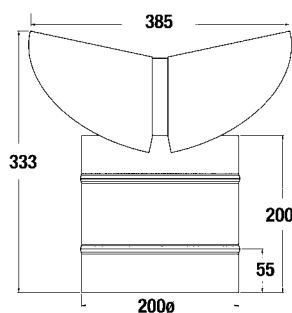

**139. RC-200 S/S**  
Roof Cowl 200ø Stainless Steel

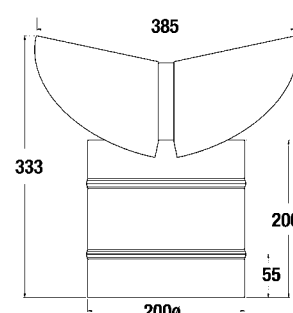

**140. RC-200**  
Roof Cowl 200ø Zinc Alumne



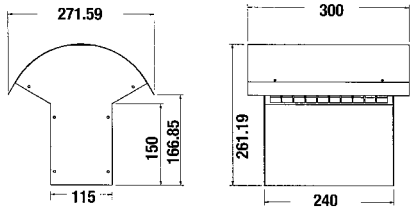

**141. RC-1 S/S**  
Roof Cowl Single Motor Stainless Steel

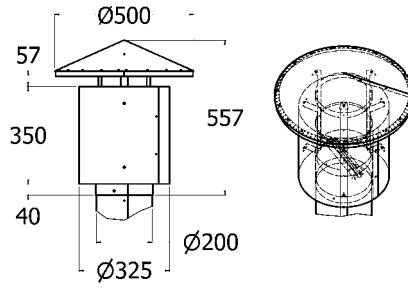

**142. FRC-200**  
Fire Rated Roof Cowl.  
Grade 445 Stainless Steel.

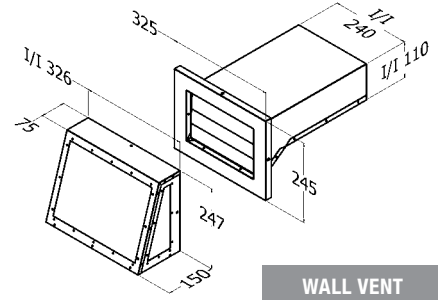

WALL VENT

**143. FRWV-H-1**  
Fire Rated Wall Vent Horizontal

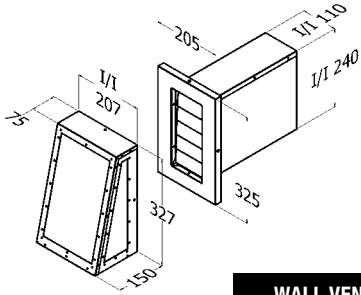

WALL VENT

**144. FRWV-V-1**  
Fire Rated Wall Vent Vertical

**WALL VENT SPECIFICATIONS**

The wall vent and wall vent cover are made from 445M2 grade stainless steel which has a higher content of the corrosion element, chromium. The wall vent covers have stainless steel screening type 316 grade and meets the requirements for stainless steel screening under the Australian Standard AS 3959-2009 Construction of Buildings in Bushfire-prone areas.

**TWIN MOTOR DUCTING**

I/D Internal Diameter

**NOTE:**

This Zinc Alum Strip is provided to join some duct pieces together. It will be clearly shown on the drawing of the piece it is supplied with.

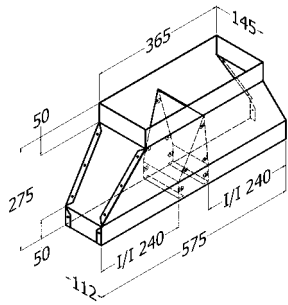
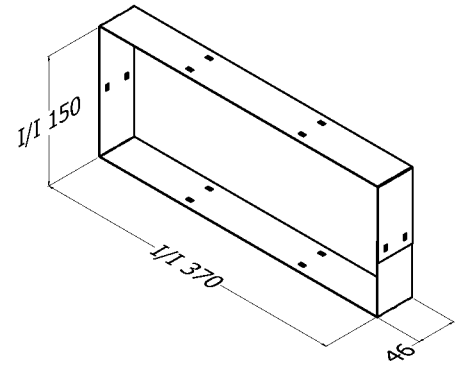
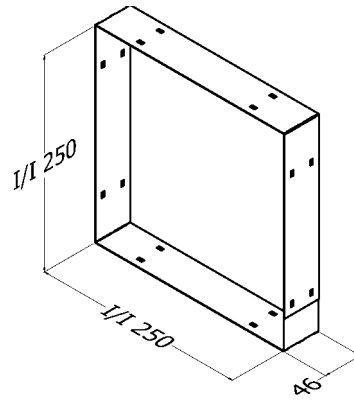

**201. TMT**  
Twin Motor Transition to DL-2

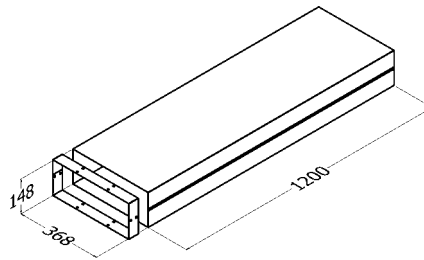

**202. DL-2**  
Duct Length 1200mm

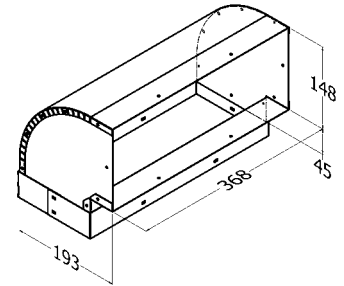

**203. HB-2**  
Horizontal Bend 90°

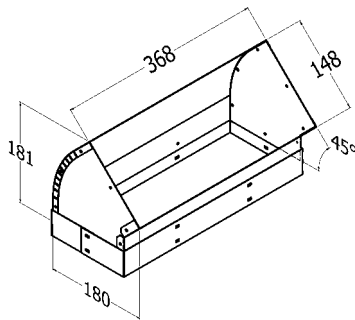

**204. HB-2/45**  
Horizontal Bend 45°

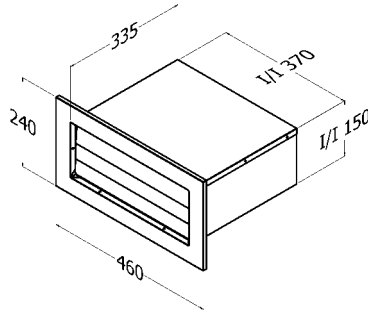

**205. BD/WV-H-2**  
Back Draft Wall Vent

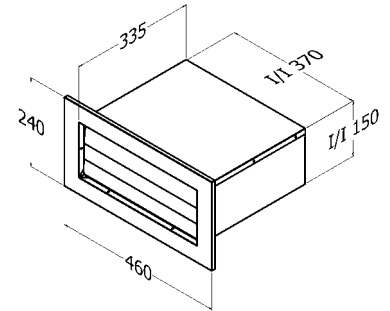

**206. BD/WV-H-2 MGS**  
Back Draft Wall Vent  
Marine Grade Stainless Steel

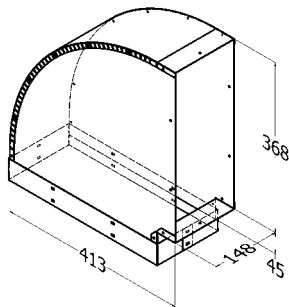

**207. VB-2**  
Vertical Bend 90°

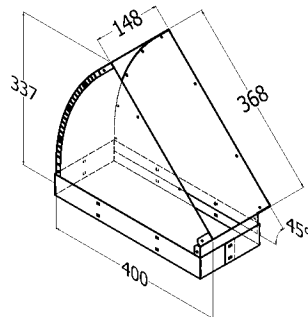

**208. VB-2/45**  
Vertical Bend 45°

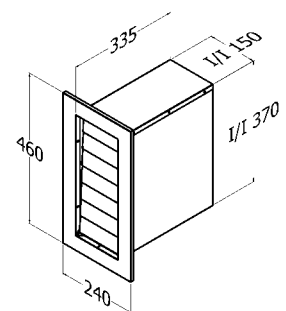

**209. BD/WV-V-2**  
Back Draft Wall Vent

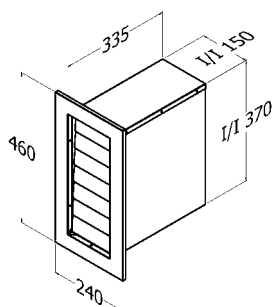

**210. BD/WV-V-2 MGS**  
Back Draft Wall Vent  
Marine Grade Stainless Steel

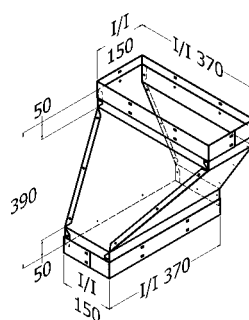

**211. TT-2**  
Twisted Transition

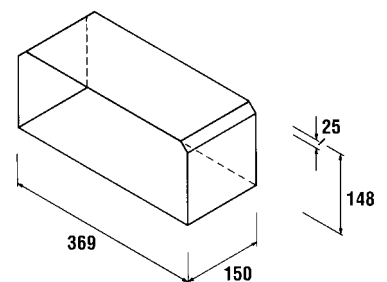

**212. DLE-2 to DLE-2**  
Flue Joiner

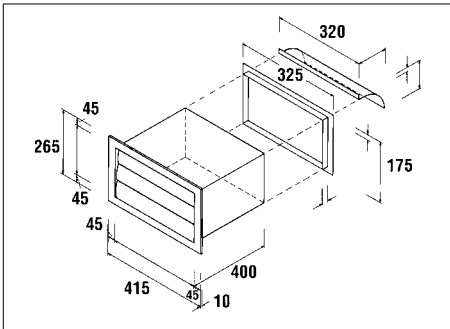

**213. BD-10/12/15-WV-R/R**  
Rear Register Kit

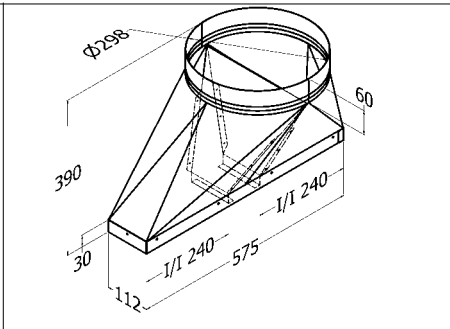

**214. TMT-300**  
Transition to 300ø

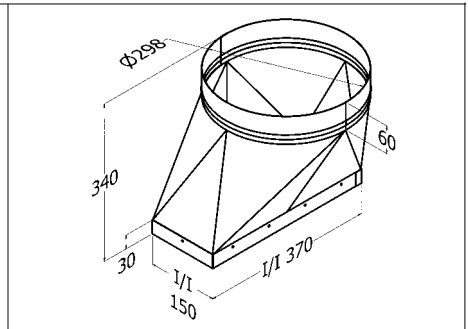

**215. TR-2**  
Transition from DL-2 to 300ø

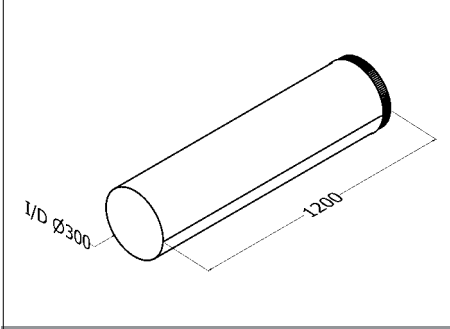

**216. DR-300**  
Duct Length 300ø 1200mm

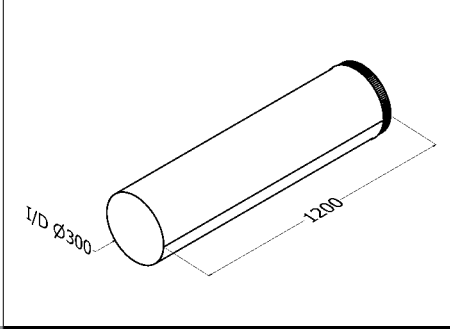

**217. DR-300 CB**  
Duct Length 300ø 1200mm Colourbond

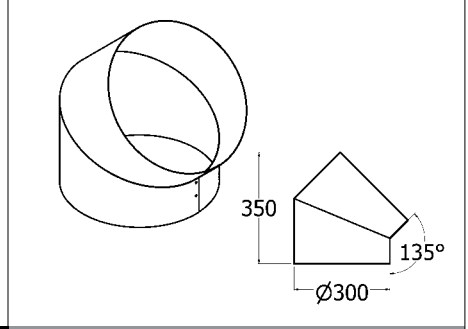

**218. DR-300/45**  
Round Bend 45°

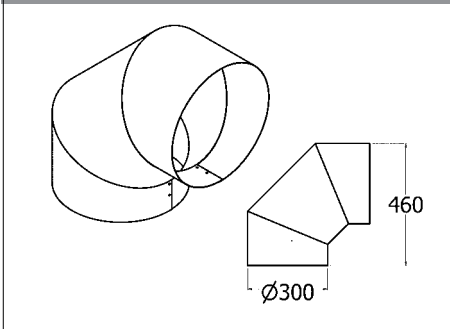

**219. DR-300/90**  
Round Bend 90°

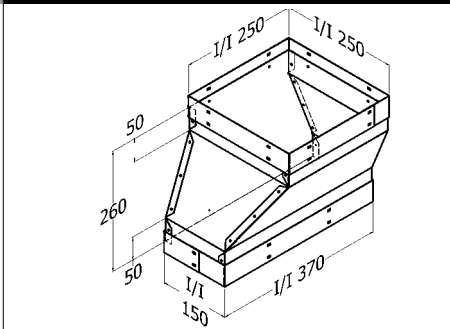

**220. DL-2 to 250SQ**  
Rectangular to Square Transition

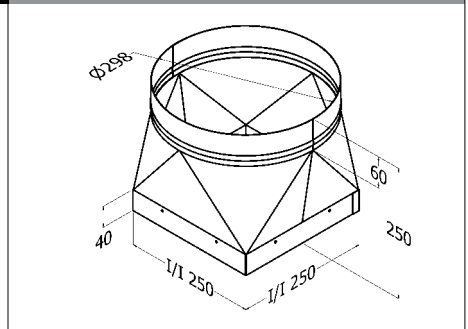

**221. TMT-250/300**  
Transition from 250sq to 300ø

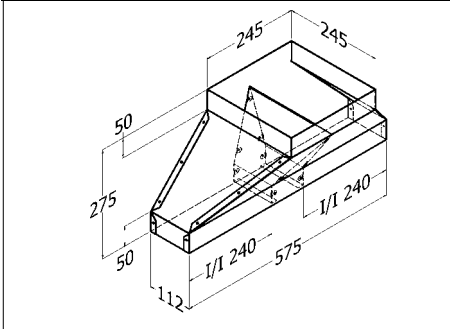

**222. TMT-250**  
Twin Motor to 250sq

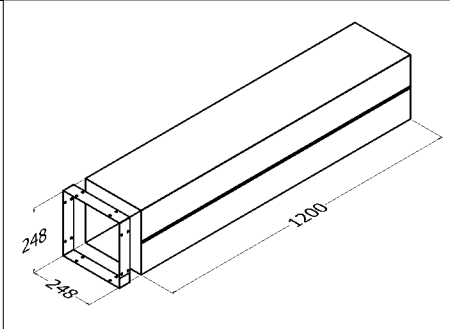

**223. DL-250**  
Duct Length 1200mm with Strap

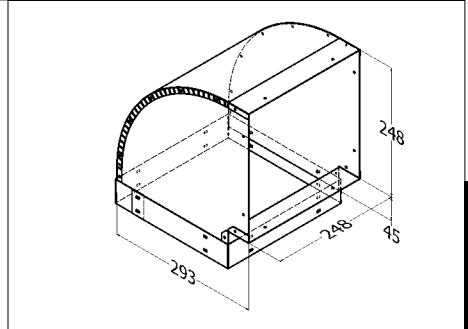

**224. HB-250**  
Horizontal Bend 90°

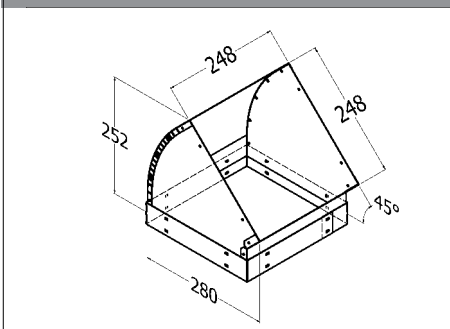

**225. HB-250/45**  
Horizontal Bend 45°

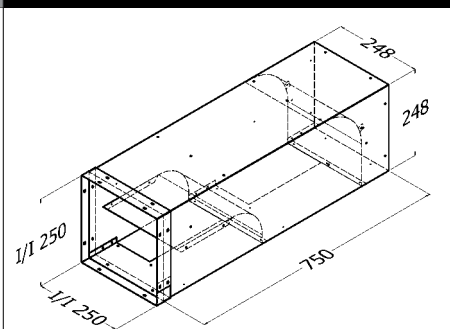

**226. TMT-250/90-L**  
Duct Deflector 250sq Left

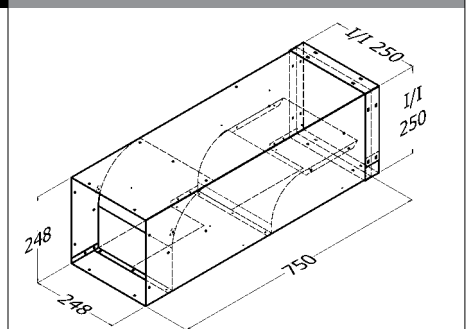

**227. TMT-250/90-R**  
Duct Deflector 250sq Right

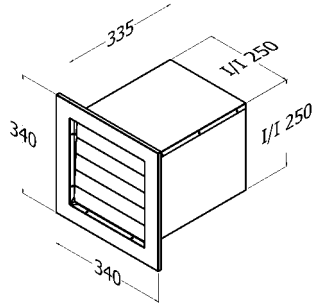

**228. BD/WV-250SQ**  
Back Draft Wall 250sq

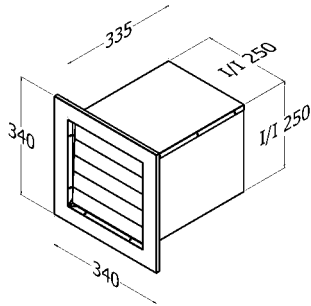

**229. BD/WV-250SQ MGS**  
Back Draft Wall 250sq Marine Grade Stainless Steel

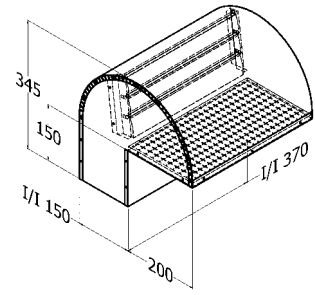

**230 BD/RC-2**  
Back Draft Roof Cowl

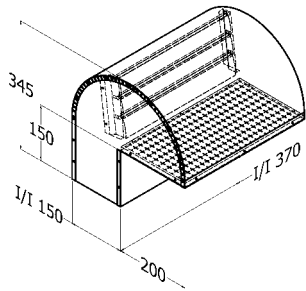

**231. BD/RC-2 CB**  
Back Draft Roof Cowl Colourbond

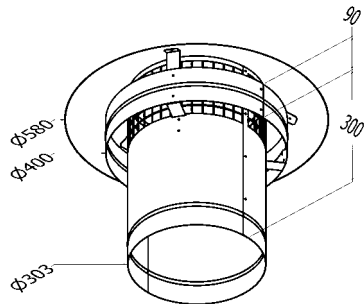

**232. CH-300**  
Chairman's Hat 300°

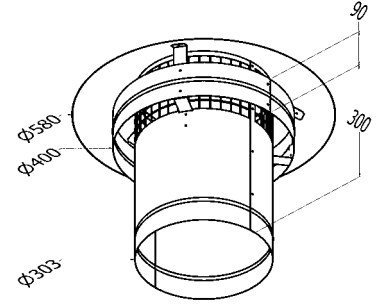

**233. CH-300 CB**  
Chairman's Hat 300° Colourbond

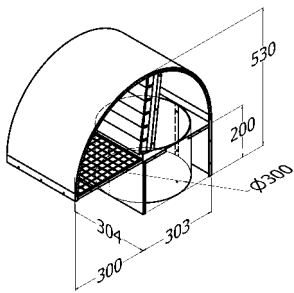

**234. BD/SQ-RC-300**  
Back Draft Roof Cowl 300°

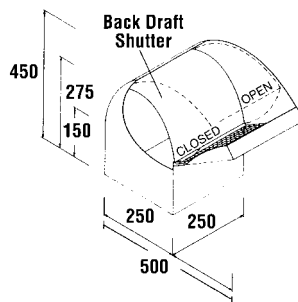

**235. BD/RC-250SQ**  
Back Draft Roof Cowl 250sq

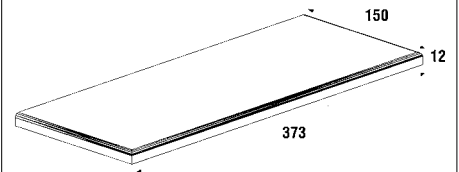

**236. DLE-2-SS CAP**  
Flue Cap

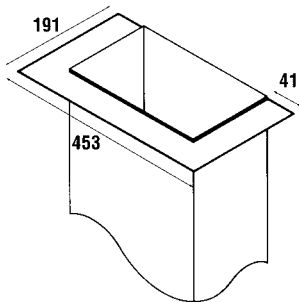

**237. CF-10/12/1500H**  
Ceiling Flange 10/12/1500H

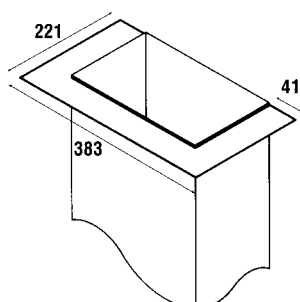

**238. CF-3F900-2**  
Ceiling Flange 3F900-2

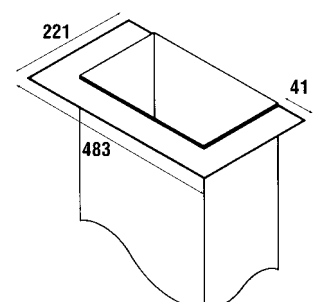

**239. CF-3F1200-2**  
Ceiling Flange 3F1200-2

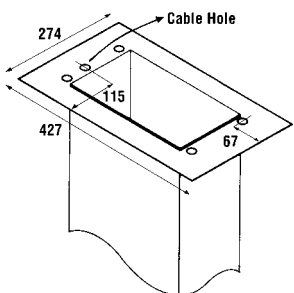

**240. CF-4F900-2**  
Ceiling Flange 4F900-2

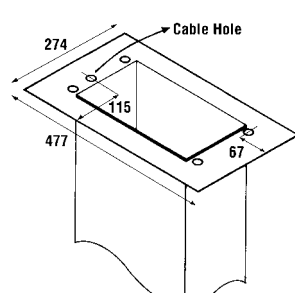

**241. CF-4F1200-2**  
Ceiling Flange 4F1200-2

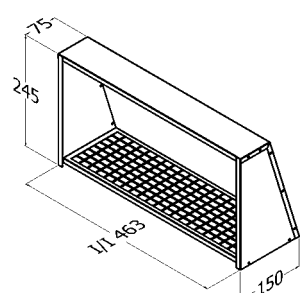

**242. WVC-H-2**  
Wall Vent Cover Horizontal

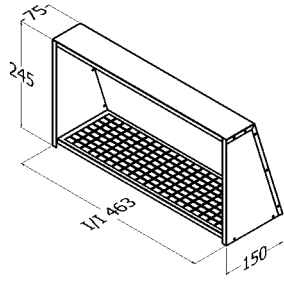

**243. WVC-H-2 MGS**  
Wall Vent Cover Horizontal  
Marine Grade Stainless Steel

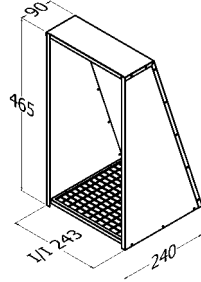

**244. WVC-V-2**  
Wall Vent Cover Vertical

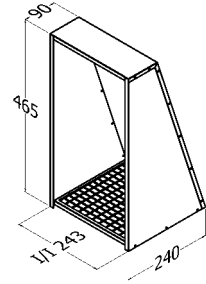

**245. WVC-V-2 MGS**  
Wall Vent Cover Vertical Marine Grade Stainless Steel

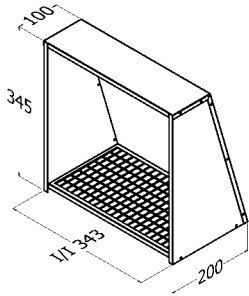

**246. WVC-250SQ**  
Wall Vent Cover 250sq

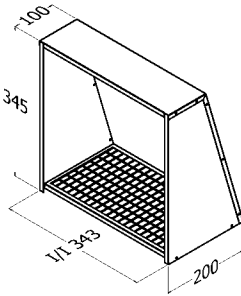

**247. WVC-250SQ MGS**  
Wall Vent Cover 250sq Marine Grade Stainless Steel

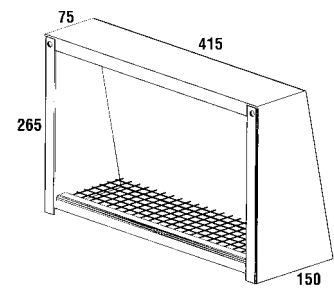

**248. WVC-10/12/1500H**  
Wall Vent Cover 10/12/1500H

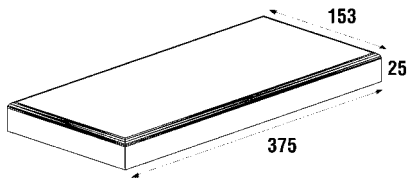

**249. 10/12/1500H-SC**  
Spigot Cap 10/12/1500H

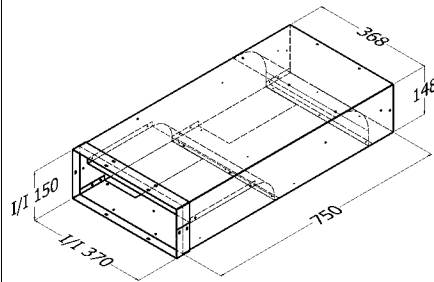

**250. DD-2H-L**  
Duct Director Horizontal Left

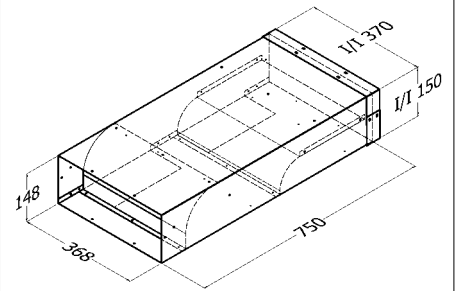

**251. DD-2H-R**  
Duct Director Horizontal Right

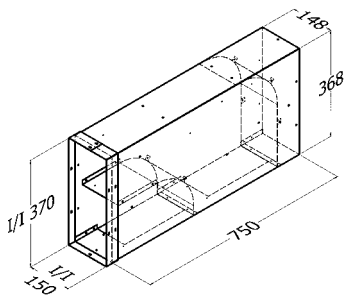

**252. DD-2V-L**  
Duct Director Vertical Left

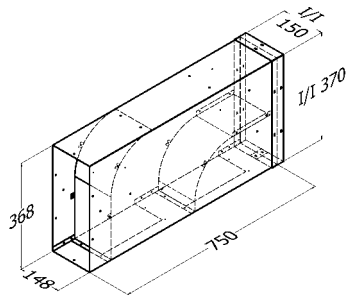

**253. DD-2V-R**  
Duct Director Vertical Right

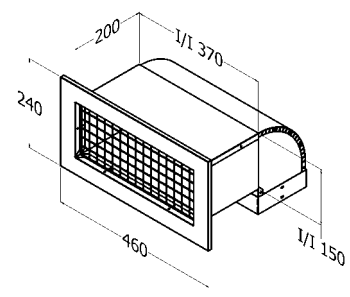

**254. EV/DL-2**  
Eave Vent to Suit DL-2

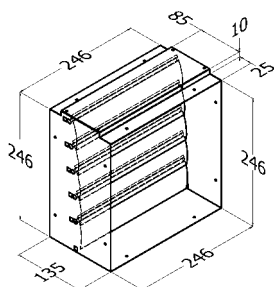

**255. BD/M-250SQ**  
Back Draft Damper 250sq

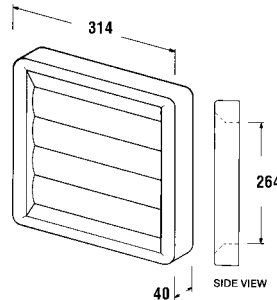

**256. AS-25**  
Back Draft Shutter

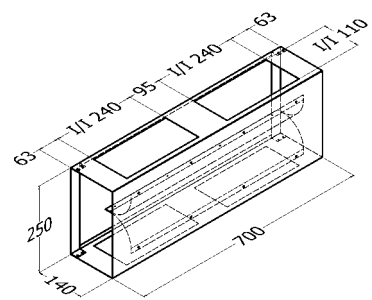

**257. BD/WVC-SBS**  
Back Draft Wall Vent Cover

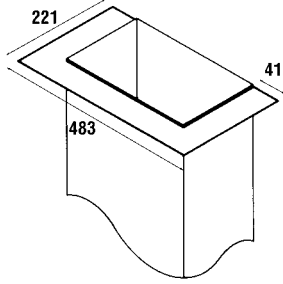

**258. CF 3F-1500-2**  
Ceiling Flange 3F-1500-2

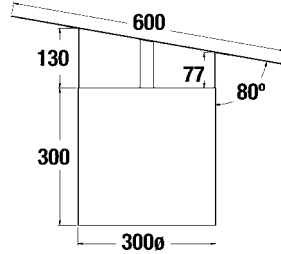

**259. RCP-300 S/S**  
Roof Cap 300Ø Stainless Steel

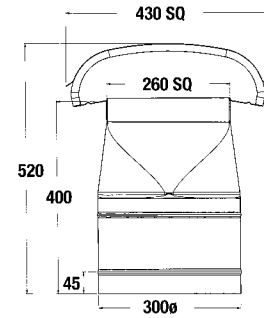

**260. RV-300 S/S**  
Roof Ventilation Cowl 300Ø Stainless Steel

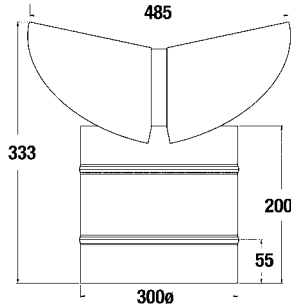

**261. RC-300 S/S**  
Roof Cowl Twin Motor Stainless Steel

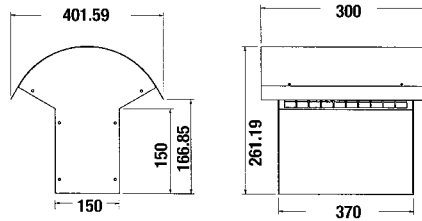

**262. RC-2 S/S**  
Roof Cowl Twin Motor Stainless Steel

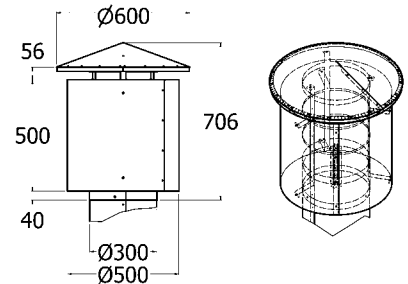

**263. FRC-300 S/SS**  
Fire Rated Roof Cowl  
Grade 445 Stainless Steel

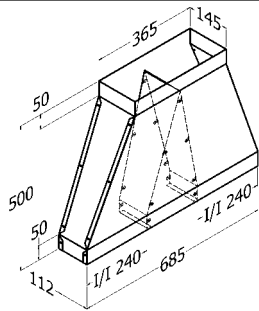

**264. TMT/CM**  
CM Rangehood Transition

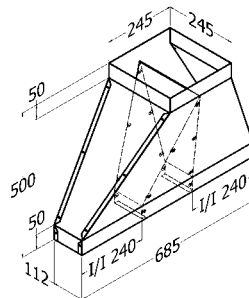

**265. TMT-250/CM**  
CM Rangehood Transition

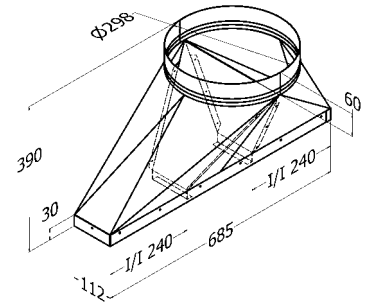

**266. TMT-300/CM**  
CM Rangehood Transition

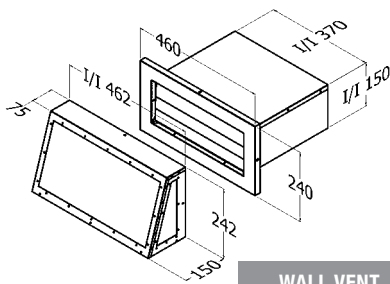

**WALL VENT**

**267. FRWV-H-2**  
Fire Rated Wall Vent Horizontal

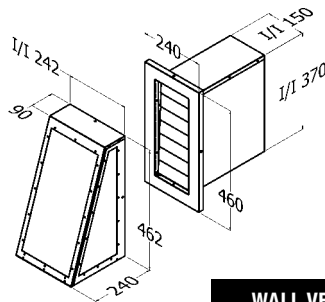

**WALL VENT**

**268. FRWV-V-2**  
Fire Rated Wall Vent Vertical

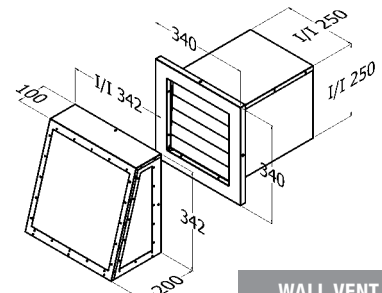

**WALL VENT**

**269. FRWV-250sq**  
Fire Rated Wall Vent 250sq

**WALL VENT SPECIFICATIONS**

The wall vent and wall vent cover are made from 445M2 grade stainless steel which has a higher content of the corrosion element, chromium. The wall vent covers have stainless steel screening type 316 grade and meets the requirements for stainless steel screening under the Australian Standard AS 3959-2009 Construction of Buildings in Bushfire-prone areas.

**TRIPLE MOTOR  
DUCTING**  
I/D Internal Diameter

**NOTE:**  
This Zinc Alume Strip is provided to join some duct pieces together. It will be clearly shown on the drawing of the piece it is supplied with.

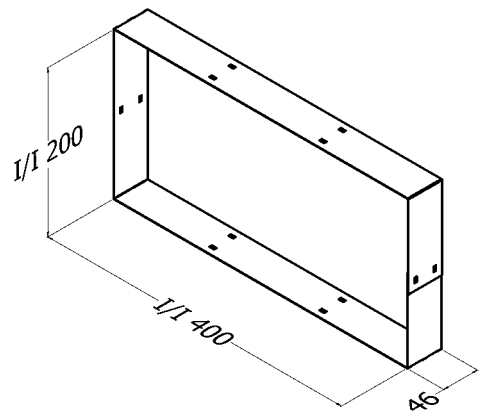

|  |   |  |
|--|---|--|
|  |   |  |
| <p><b>301. 3MT-DL-3</b><br/>Three Motor Transition</p> | <p><b>302. DL-3</b><br/>Duct Length 1200mm</p>                      | <p><b>303. HB-3</b><br/>Horizontal Bend 90°</p>  |
|  |   |  |
| <p><b>304. HB-3/45</b><br/>Horizontal Bend 45°</p>     | <p><b>305. VB-3</b><br/>Vertical Bend 90°</p>                       | <p><b>306. VB-3/45</b><br/>Vertical Bend 45°</p> |
|  |   |  |
| <p><b>307. TT-3</b><br/>Twisted Transition</p>         | <p><b>308. TMT-400x200/350</b><br/>Transition from DL-3 to 350ø</p> | <p><b>309. TR-3</b><br/>Transition to 350ø</p>   |
|  |   |  |
| <p><b>310. DR-350</b><br/>Duct Length 350ø</p>         | <p><b>311. DR-350 CB</b><br/>Duct Length 350ø Colourbond</p>        | <p><b>312. DR-350/45</b><br/>Bend 45° 350ø</p>   |

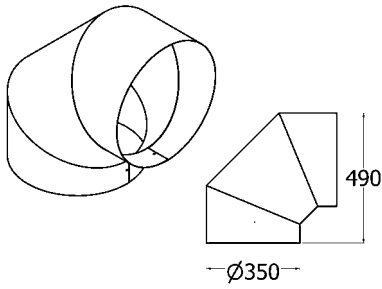

**313. DR-350/90**  
Bend 90° 350ø

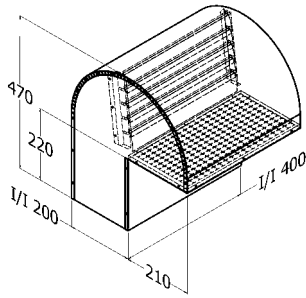

**314. BD/RC-3**  
Back Draft Roof Cowl

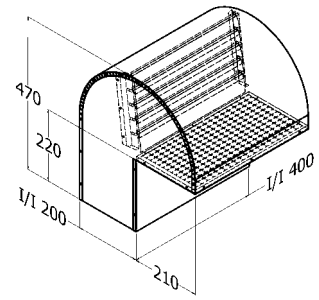

**315. BD/RC-3 MGS**  
Back Draft Roof Cowl Marine Grade Stainless Steel

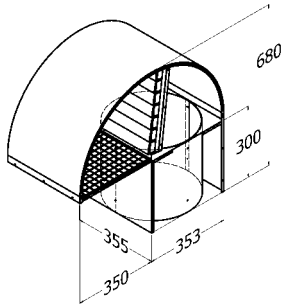

**316. BD/SQ-RC350**  
Back Draft Roof Cowl 350ø

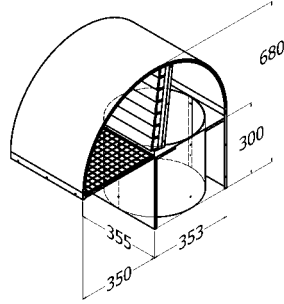

**317. BD/SQ-RC350 MGS**  
Back Draft Roof Cowl 350ø  
Marine Grade Stainless Steel

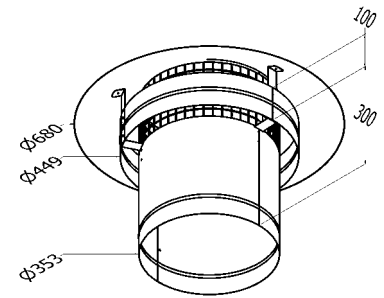

**318. CH-350**  
Chairmans Hat 350ø

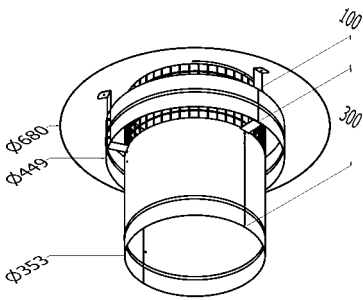

**319. CH-350 CB**  
Chairmans Hat 350ø Colurbond

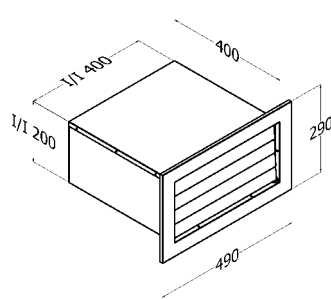

**320. BD/WV-H-3**  
Back Draft Wall Vent Horizontal

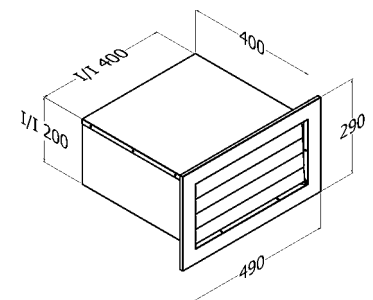

**321. BD/WV-H-3 MGS**  
Back Draft Wall Vent Horizontal  
Marine Grade Stainless Steel

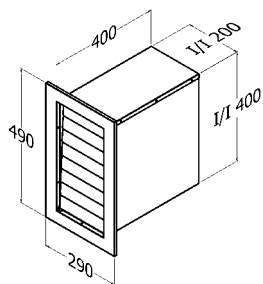

**322. BD/WV-V-3**  
Back Draft Wall Vent Vertical

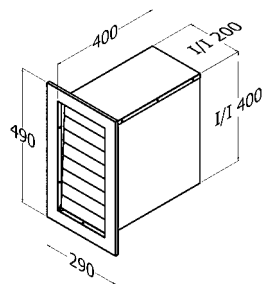

**323. BD/WV-V-3 MGS**  
Back Draft Wall Vent Vertical Marine Grade Stainless Steel

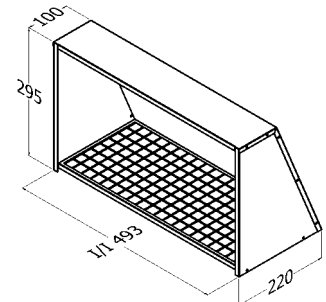

**324. WVC-H-3**  
Wall Vent Cover Horizontal

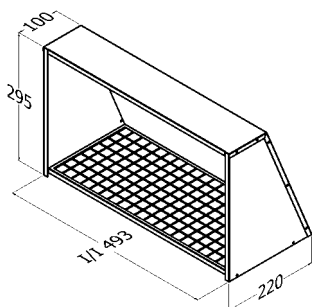

**325. WVC-H-3 MGS**  
Wall Vent Cover Horizontal  
Marine Grade Stainless Steel

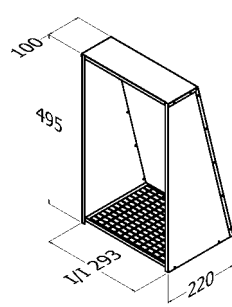

**326. WVC-V-3**  
Wall Vent Cover Vertical

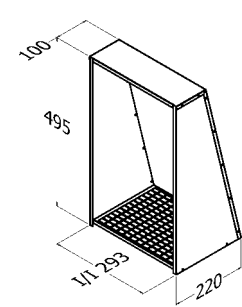

**327. WVC-V-3 MGS**  
Wall Vent Cover Vertical Marine Grade Stainless Steel



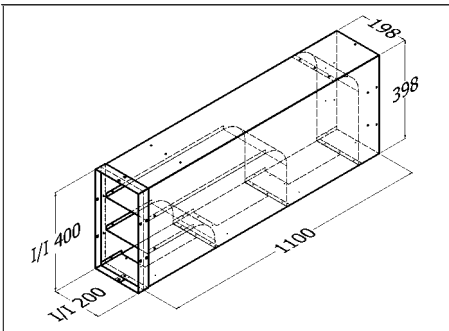

**328. DD-3V-L**  
Duct Director Vertical Left

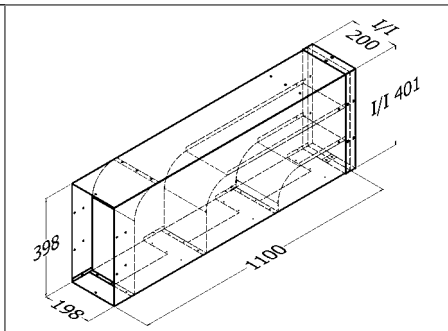

**329. DD-3V-R**  
Duct Director Vertical Right

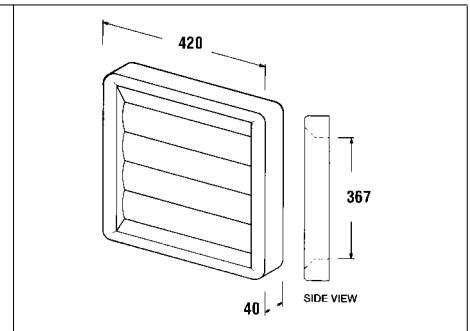

**330. AS-35**  
Back Draft Shutter

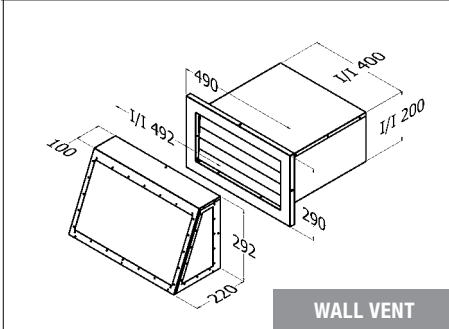

WALL VENT

**331. FRWV-H-3**  
Fire Rated Wall Vent Horizontal

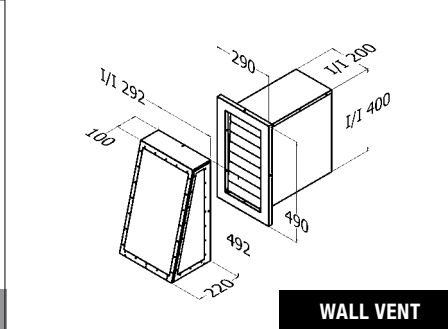

WALL VENT

**332. FRWV-V-3**  
Fire Rated Wall Vent Vertical

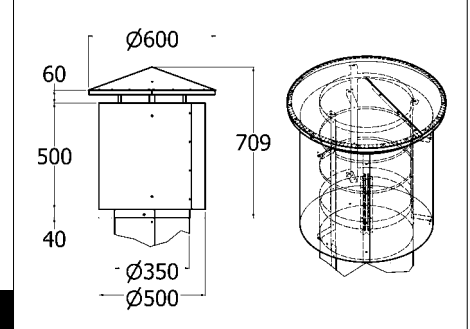

**333. FRC-350**  
Fire Rated Roof Cowl

#### WALL VENT SPECIFICATIONS

The wall vent and wall vent cover are made from 445M2 grade stainless steel which has a higher content of the corrosion element, chromium. The wall vent covers have stainless steel screening type 316 grade and meets the requirements for stainless steel screening under the Australian Standard AS 3959-2009 Construction of Buildings in Bushfire-prone areas.

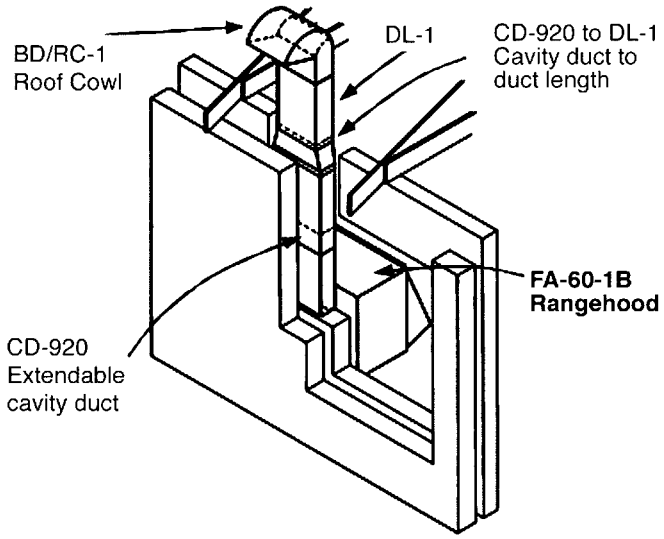

1. FA 60-1B

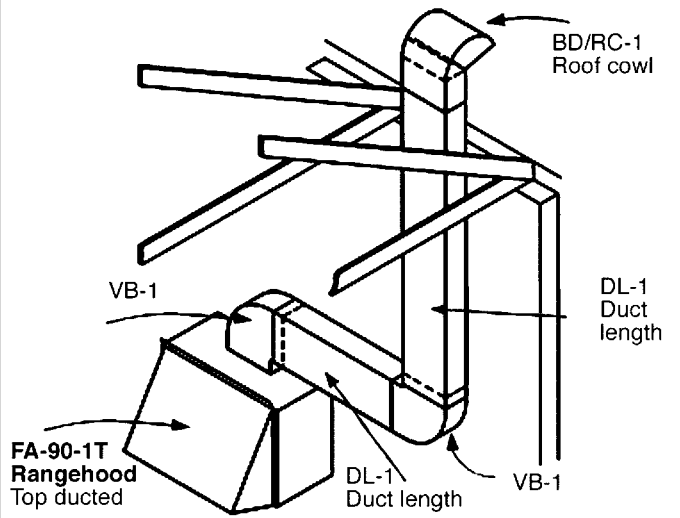

2. FA 90-1T

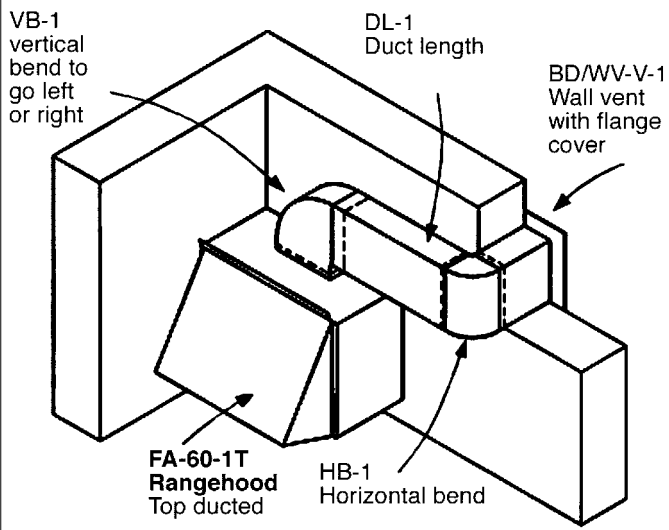

3. FA 60-1T

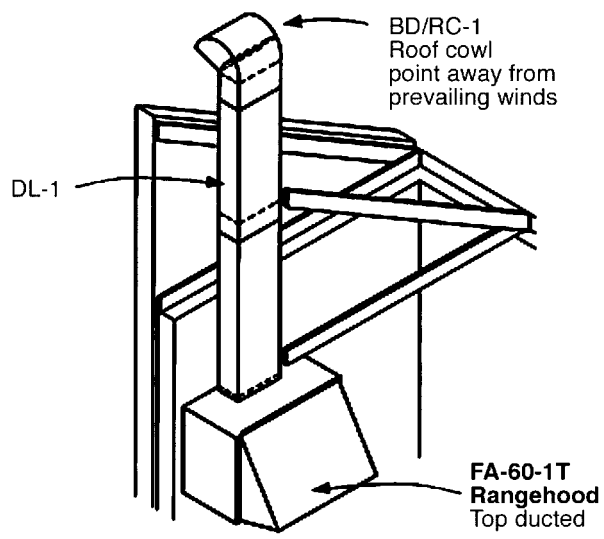

4. FA 60-1T

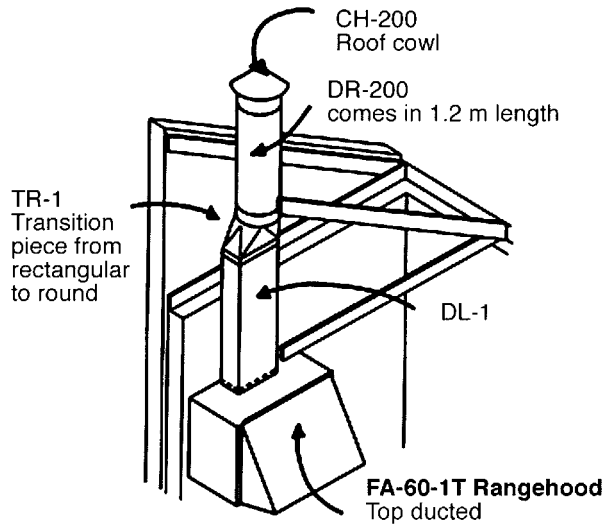

5. FA 60-1T

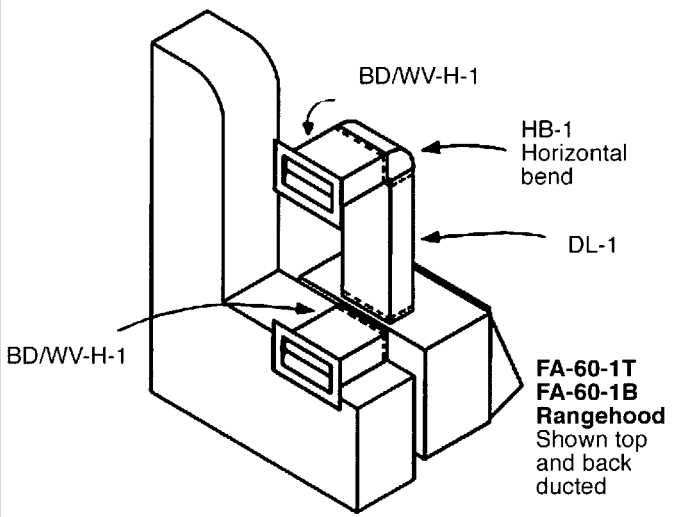

6. FA 60-1T / FA 60-1B

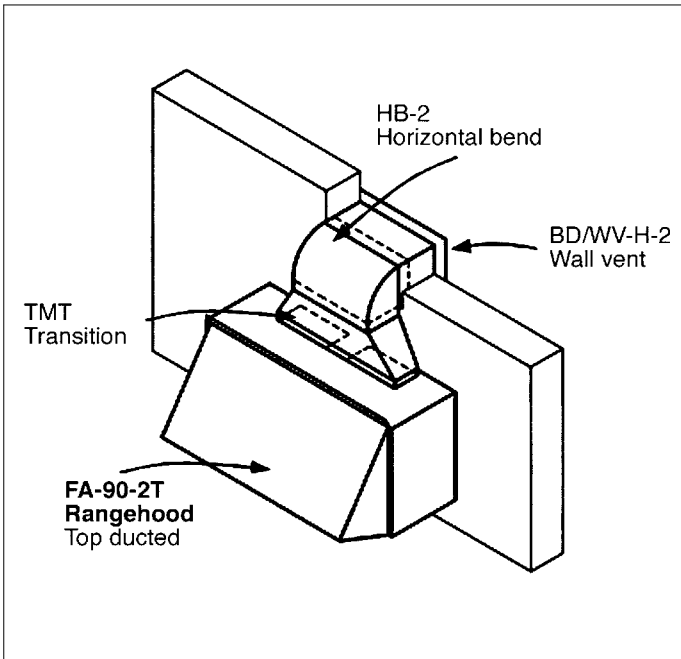

7. FA 90-2T

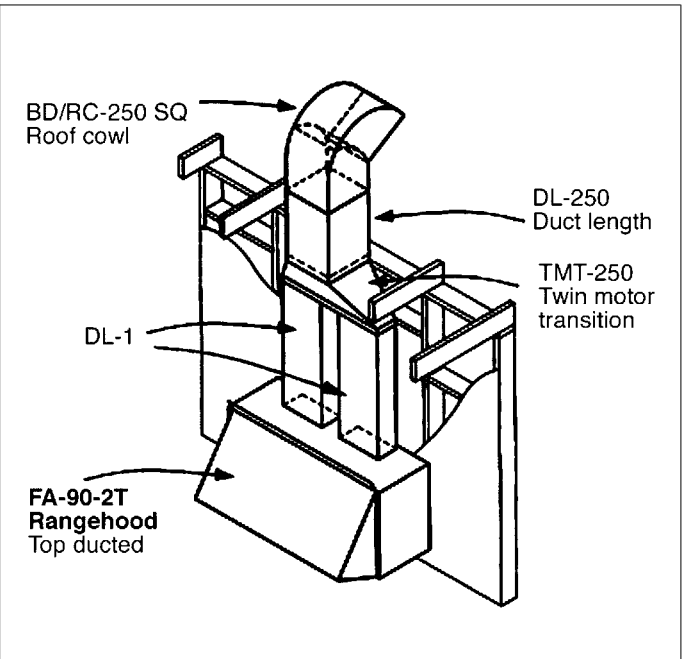

8. FA 90-2T

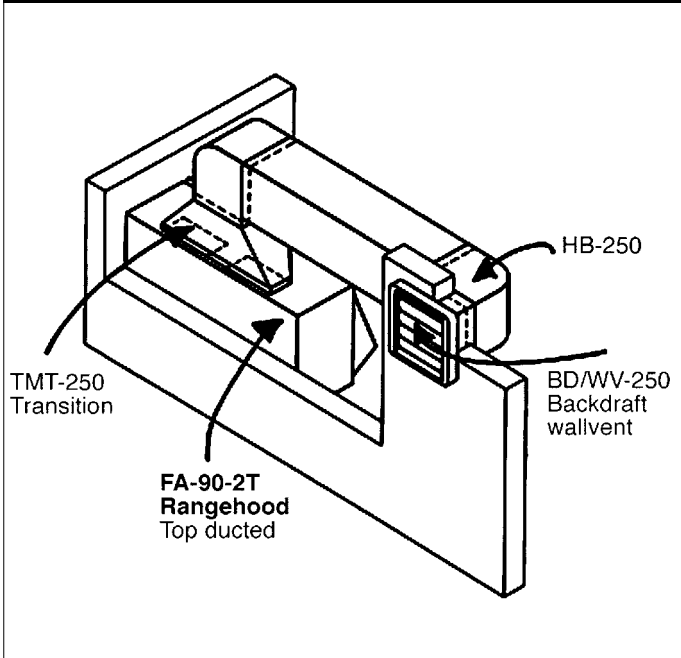

9. FA 90-2T

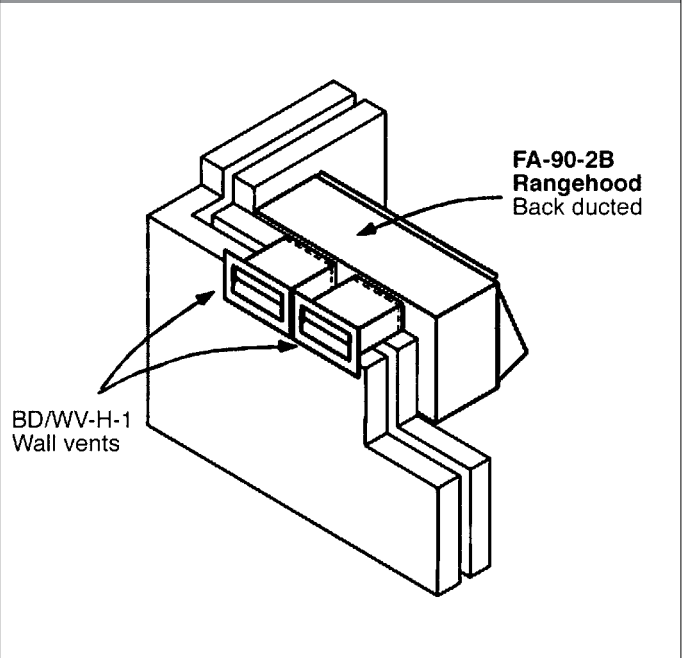

10. FA 90-2B

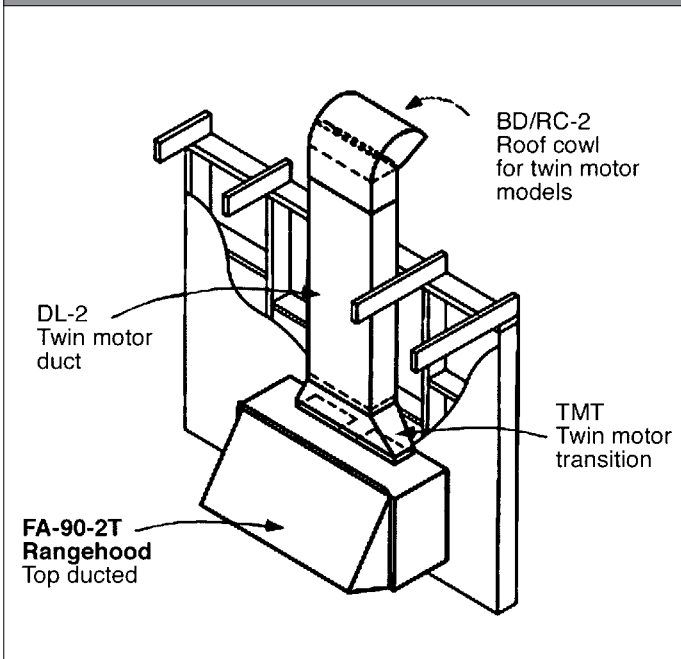

11. FA 90-2T

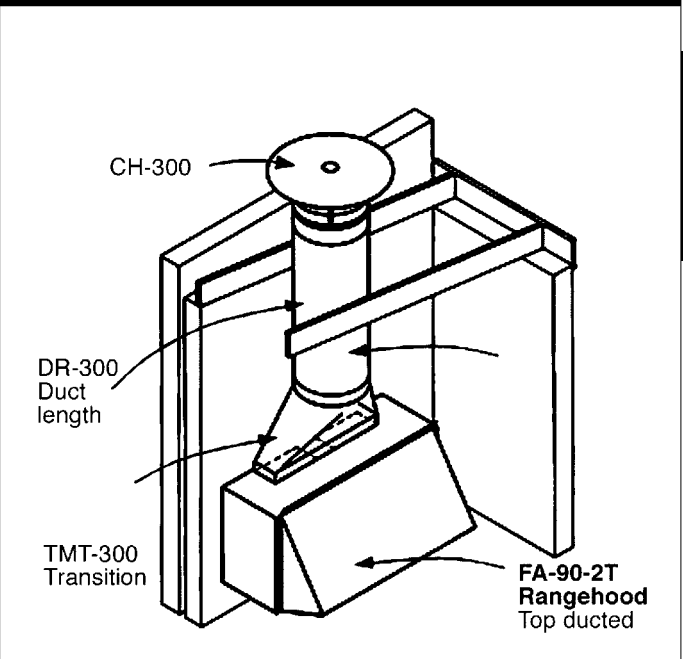

12. FA 90-2T

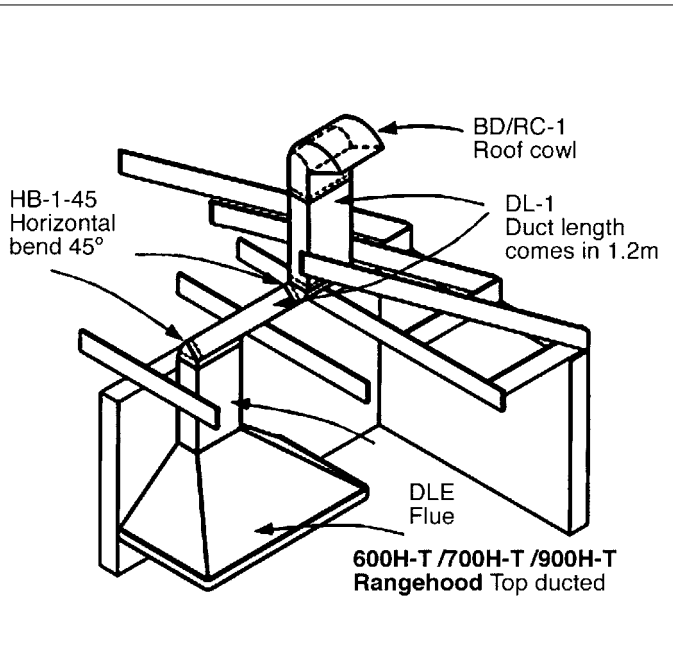

13. 600H-T / 700H-T / 900H-T

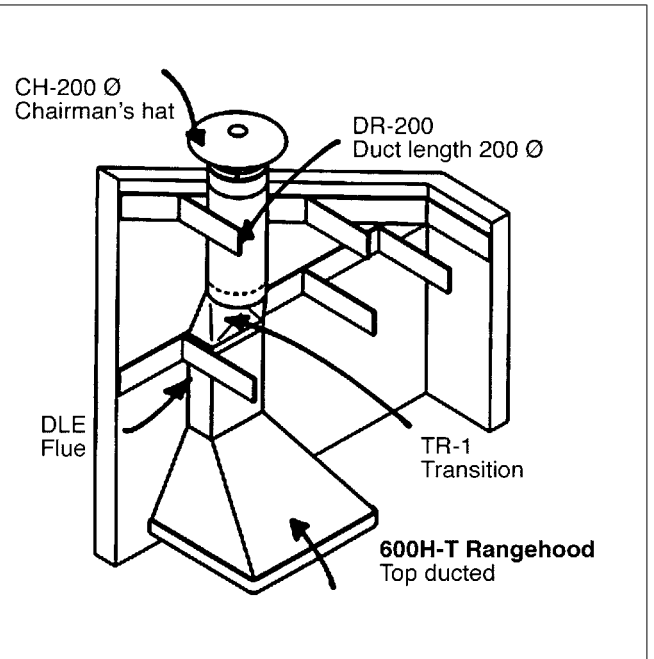

14. 600H-T

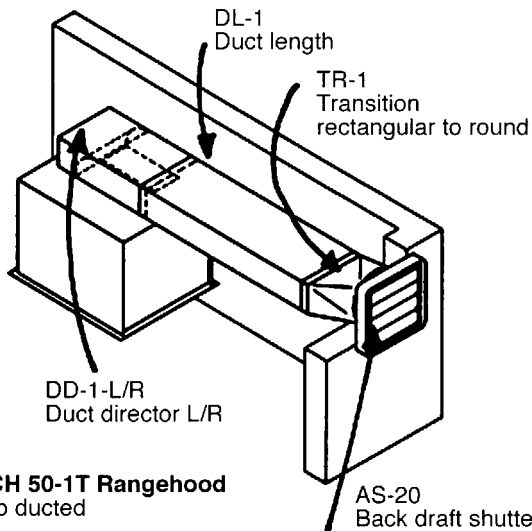

15. UCH 50-1T

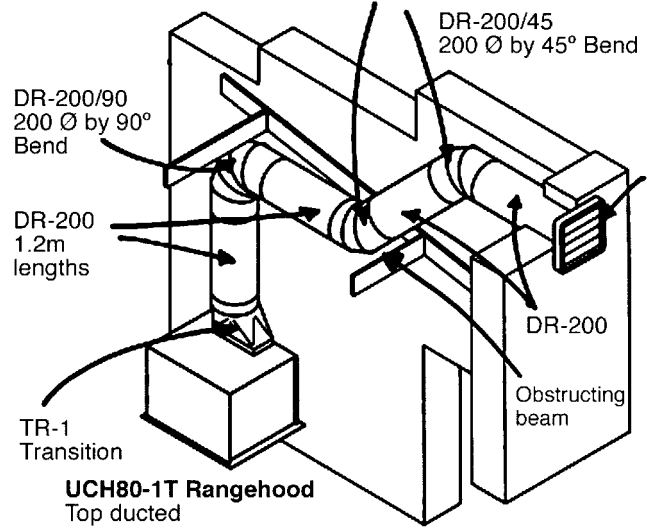

16. UCH 80-1T

18

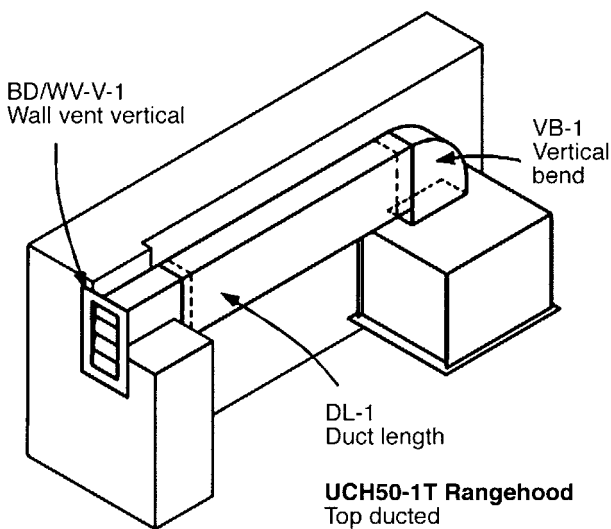

17. UCH 50-1T

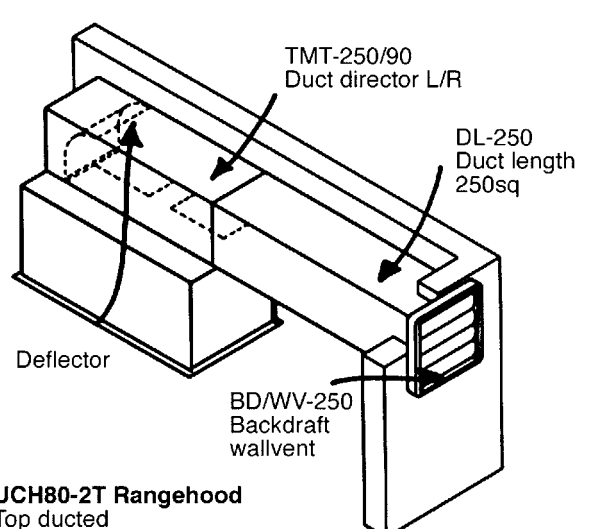

18. UCH 80-2T

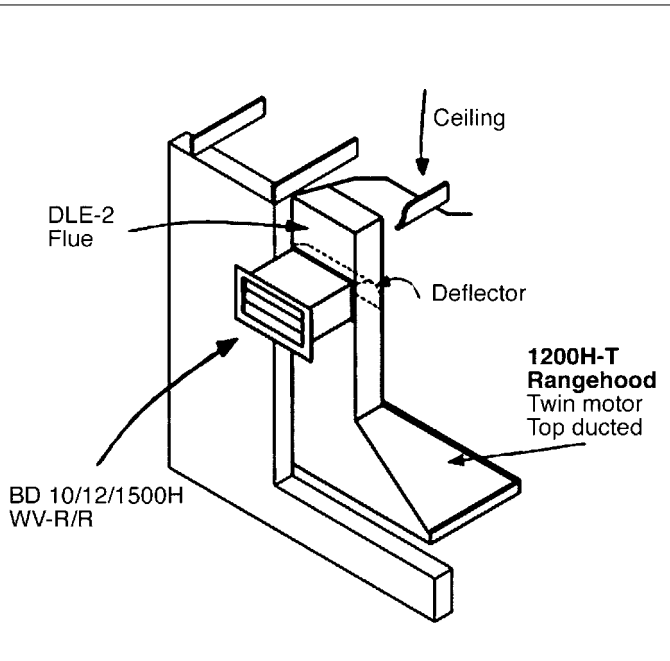

19. 1200H-T

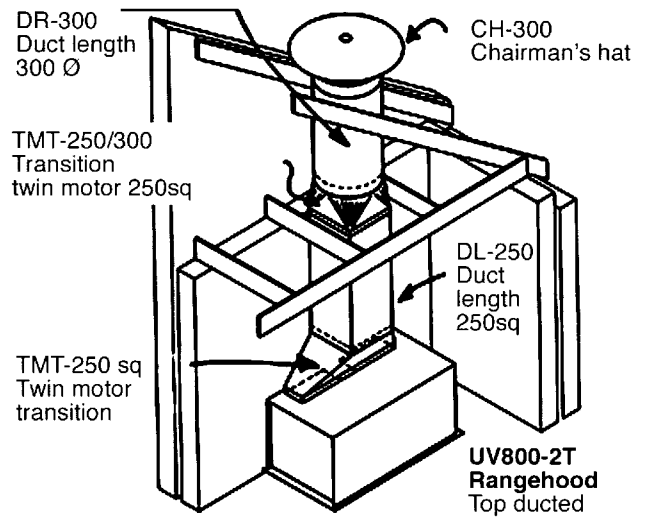

20. UV 800-2T

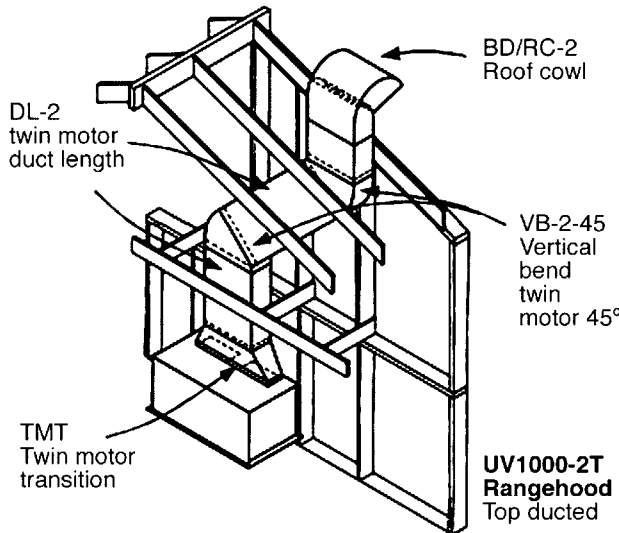

21. UV 1000-2T

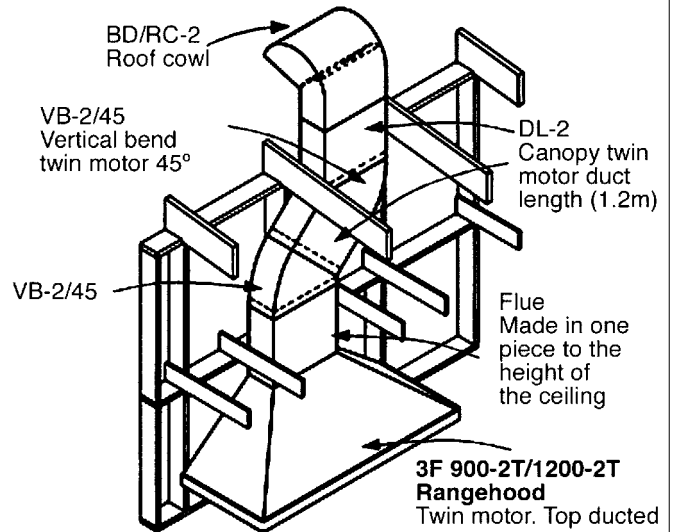

22. 3F 900-2T / 1200-2T

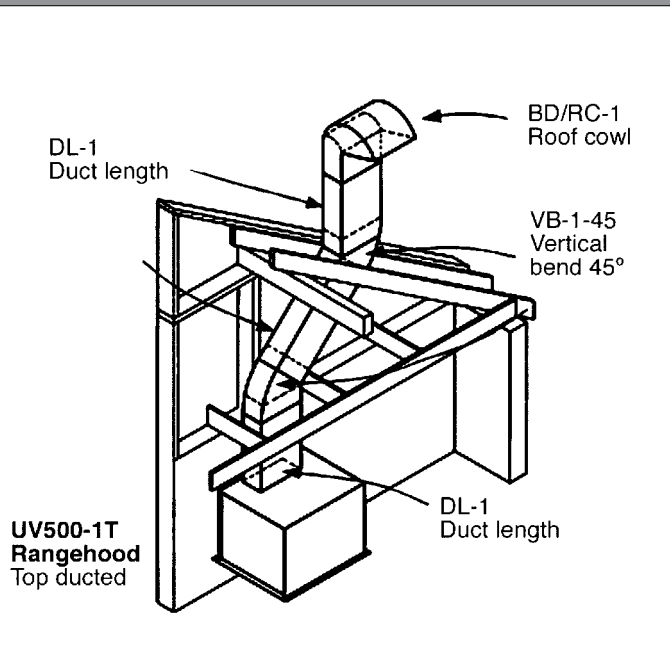

23. UV 500-1T

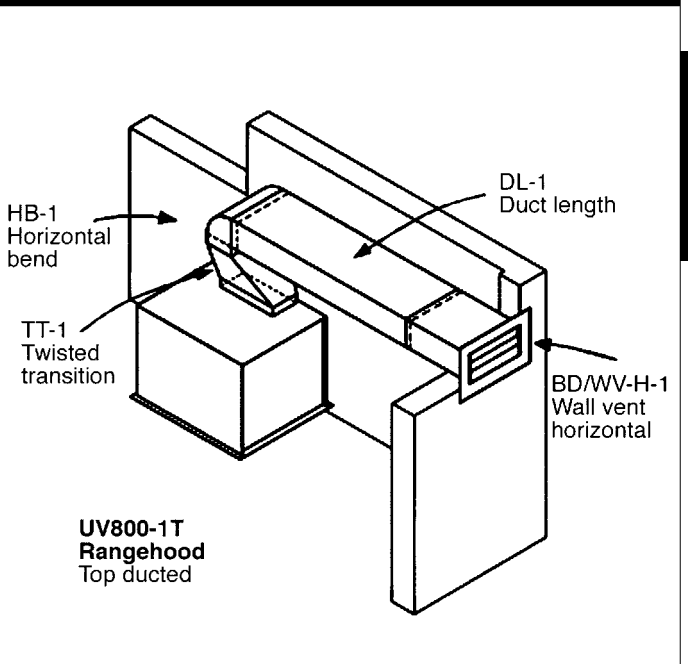

24. UV 800-1T

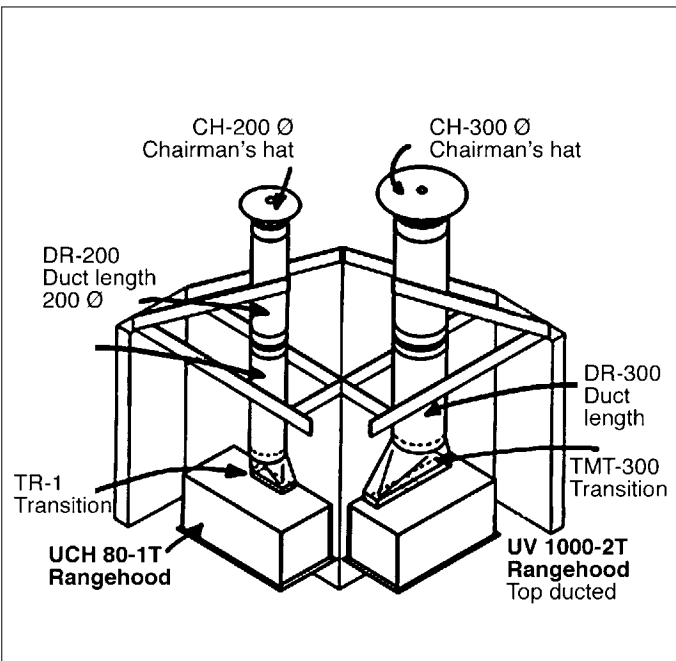

25. UCH 80-1T / UV 1000-2T

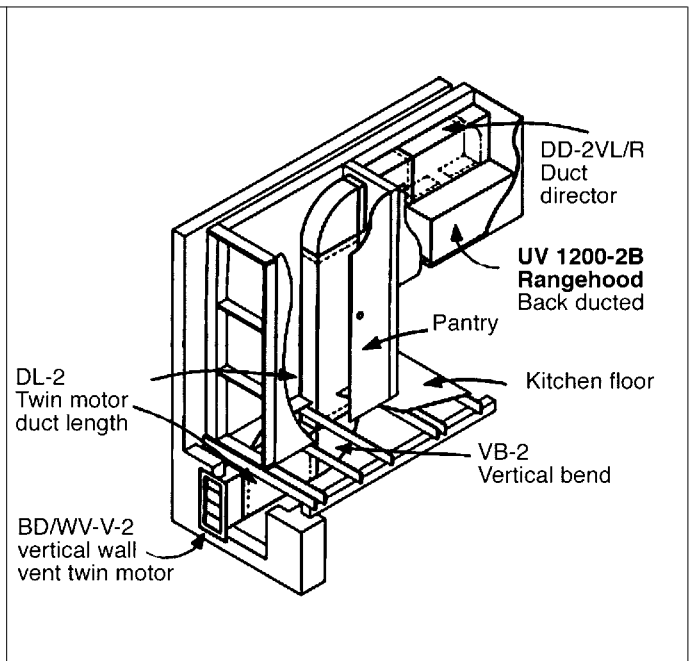

26. UV 1200-2B

# NOTES

A series of horizontal dashed lines for taking notes.





DISTRIBUTED IN AUSTRALIA BY CONDARI PTY LTD

Tel: 1300 360 563

VIC / TAS Tel: +61 3 9482 7088

Fax: +61 3 9482 7011

Email: sales@qasair.com.au

Website: www.qasair.com.au

**YOUR DISTRIBUTORS**

**Australia**

NSW / ACT Tel: +61 2 9316 4599

Fax: +61 2 9316 9299

Email: salesnsw@qasair.com.au

QLD Tel: +61 7 3423 3503

Fax: +61 7 3282 9122

Email: salesqld@qasair.com.au

WA Tel: +61 8 9242 5387

Fax: +61 8 9201 0887

Email: saleswa@qasair.com.au

SA / NT Tel: 1300 360 563

Fax: +61 3 9482 7011

Email: salessa@qasair.com.au

**New Zealand**

Kitchen Appliance Specialists Ltd

320 Manchester Street

Christchurch New Zealand

Tel: +64 3 379 0360

Fax: +64 3 365 5623

Kouzina Appliances

155 The Strand, Parnell Auckland New Zealand

Tel: +64 9 377 7822

Fax: +64 9 377 7824

**Singapore**

Eldric Marketing Pte Ltd, 176 Orchard Road

#05-03 Centrepont Singapore 238843

Tel: +65 6339 1188

Fax: +65 6733 8133

07/14 F



[www.qasair.com.au](http://www.qasair.com.au)

[www.condari.com.au](http://www.condari.com.au)

**QASAIR RANGEHOODS MADE IN RINGWOOD 3134**

QASAIR RESERVES THE RIGHT TO CHANGE SPECIFICATION WITHOUT NOTICE.

® IS A REGISTERED TRADE MARK.

PRINTED IN AUSTRALIA